

DISCLAIMER: The Block Design Collective ("BDC") does not make any representations or warranties with respect to the accuracy or suitability of this information, and persons making use of this information do so at their own risk. BDC disclaims liability for damages of any kind, including any special, indirect, or consequential damages, which may result from use of this information. This information is not to be interpreted as indicating compliance with, or waiver of, any applicable building code, ordinance, standard or law.

DESIGNER NOTES:

DESIGN REQUIREMENTS

1.

POST INSTALLED DOWELS CAN BE CONSIDERED AND EPOXY INSTALLED REINFORCEMENT IS COMMONLY USED.
2.

6" MINIMUM SLAB THICKNESS SHOWN BASED ON HOOKED DOWEL REQUIREMENTS. THINNER SLAB MAY BE CONSIDERED BASED ON DESIGN LOADS.

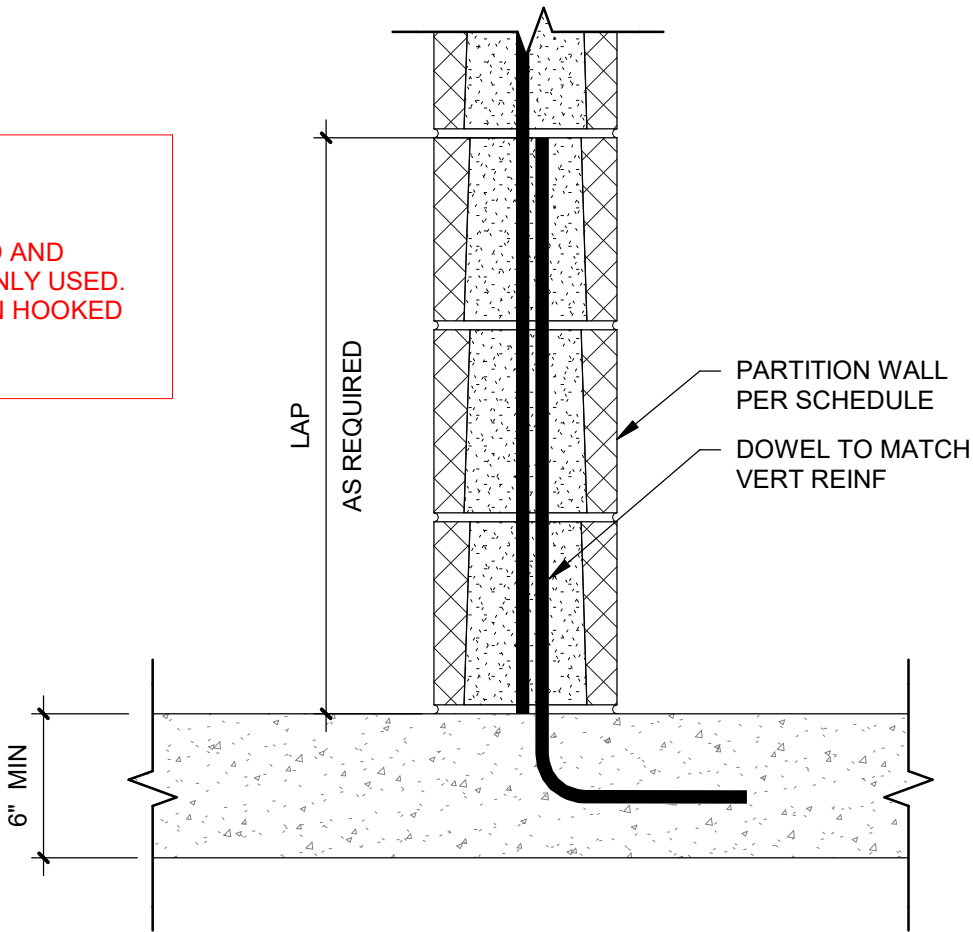

9

TYPICAL PARTITION WALL

SCALE: 1 1/2" = 1'-0"